

Pretty Plastic Panels (Basic Third)

Installation Guide

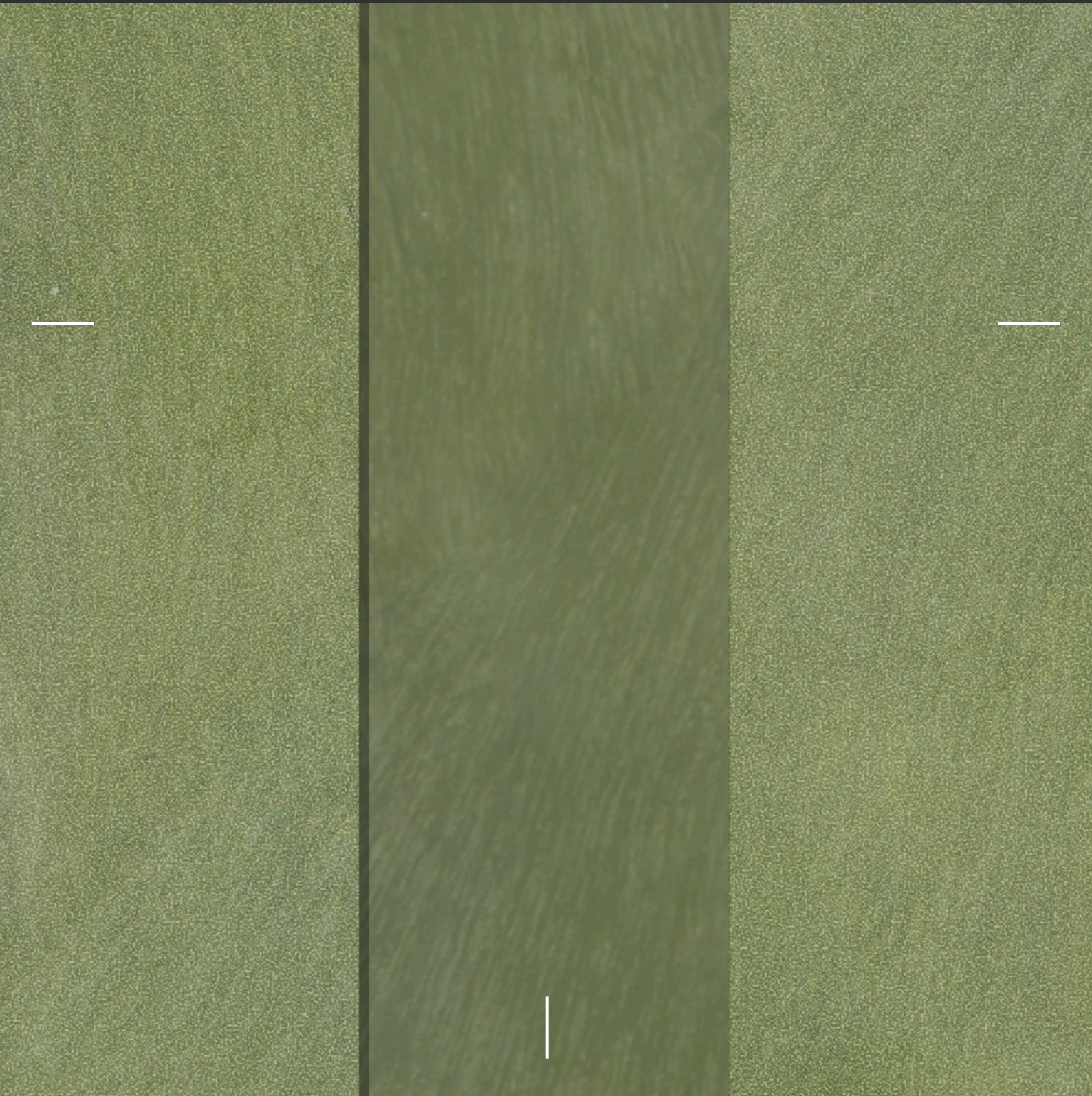



building from waste

info@prettyplastic.nl
www.prettyplastic.nl
@we_are_prettyplastic

BASIC THIRD INSTALLATION MANUAL

October 2024

INSTALLATION MANUAL

PRODUCT NAME BASIC THIRD

TECHNICAL DATA

HEIGHT	569 mm
WIDTH	329 mm
THICKNESS	30 mm

NUMBER OF TILES PER M ²	6.7
WEIGHT PER TILE	2.1 kg
WEIGHT PER M ²	14.1 kg

MATERIAL	recycled Polyvinylchlorid (PVC)
----------	---------------------------------

FLAMMABILITY (EN 13501-1:2018)	B-s3, d0
--------------------------------	----------

PRODUCTION TOLERANCES	+/-2%
-----------------------	-------

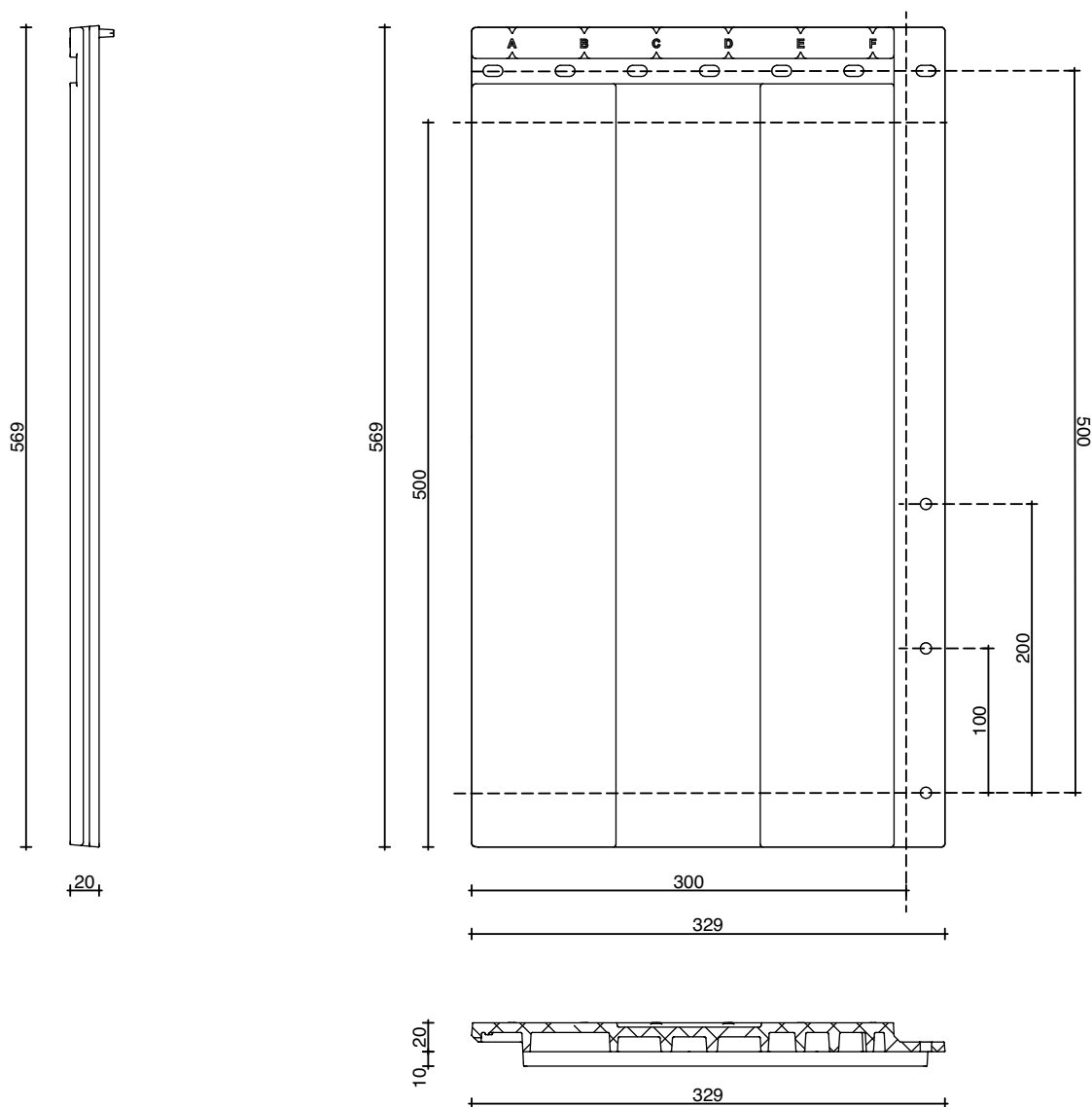

INSTALLATION MANUAL

PRODUCT NAME BASIC THIRD



PRODUCT

Pretty Plastic tiles are utilized in ventilated facades, catering to both renovation projects and newly constructed facades.

PROCESSING

Pretty Plastic can be cut or drilled without producing any splinters. Tiles can be cut using a jigsaw, circular saw, or handsaw. Always use an appropriate shop vac when cutting tiles with a power saw to prevent the sawdust from spreading into the environment. Collect sawing waste and cutting losses separately to prevent them from being blown away. Make sure to manage these waste materials properly.

APPLICATION

- Pretty Plastic tiles can be installed at angles up to a maximum of 45 degrees, given the application of a water-retaining layer.
- It's important to note that the structural engineer holds the final responsibility for ensuring the accurate installation and application of the tiles.

PAINTING

Please note that Pretty Plastic tiles are not intended for painting.

MAINTENANCE

Pretty Plastic is maintenance-free and can be cleaned using household cleaning products.

INSTALLATION

Pretty Plastic tiles should be attached to a wall with an underlying wooden structure composed of wooden slats (C18); these should have a minimum dimension of 24x48mm or 28x45mm, which are commonly available sizes in the EU.

Secure each tile to the slat construction using screws. We recommend using SPAX Universal Screw 25/45x4mm or an equivalent product for this purpose.

- Install horizontal slats with a 500 mm spacing on a vertical substructure set 600 mm apart.
- The vertical substructure creates a ventilated cavity.
- Include ventilation openings at both the top and bottom ends of the facade.
- Secure each tile using either one or three screws, depending on the building's height and the local wind load according to NEN-EN 1991-1-4 . Check our technical guide for detailed information.
- Maintain a 10 mm seam for a center-to-center distance of 300 mm.
- For corner ends and window frame connections, refer to the proposed detail drawings for various possible solutions.

INSTALLATION MANUAL

PRODUCT NAME BASIC THIRD

WOODEN STRUCTURE

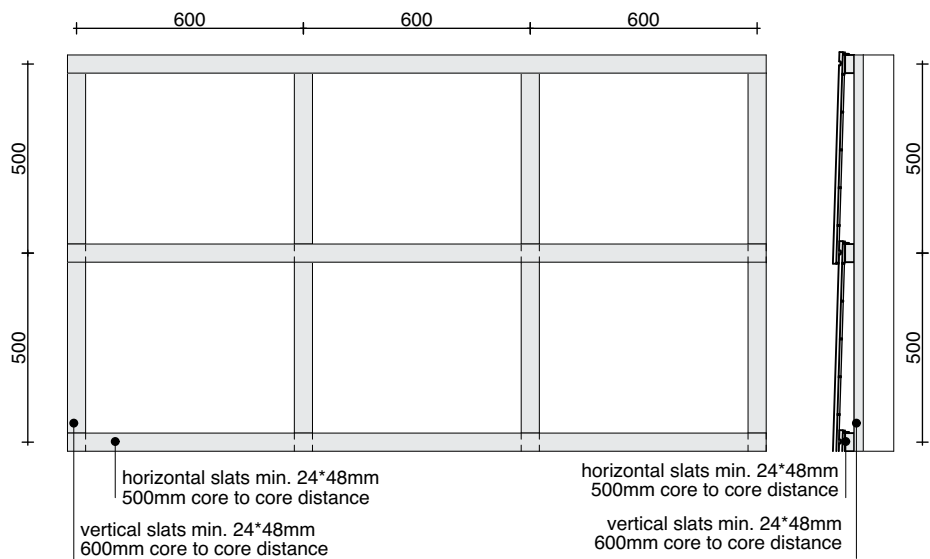

TILE PATTERN

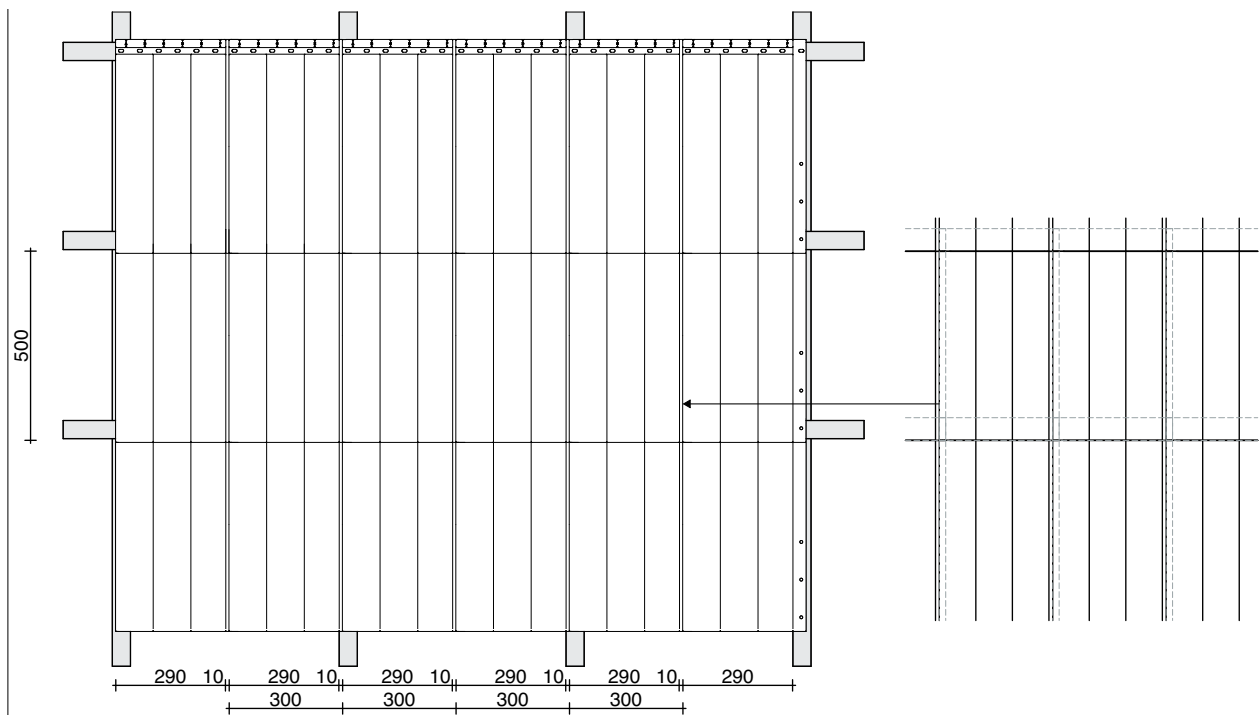

INSTALLATION MANUAL

PRODUCT NAME BASIC THIRD

MEASURE PLAN

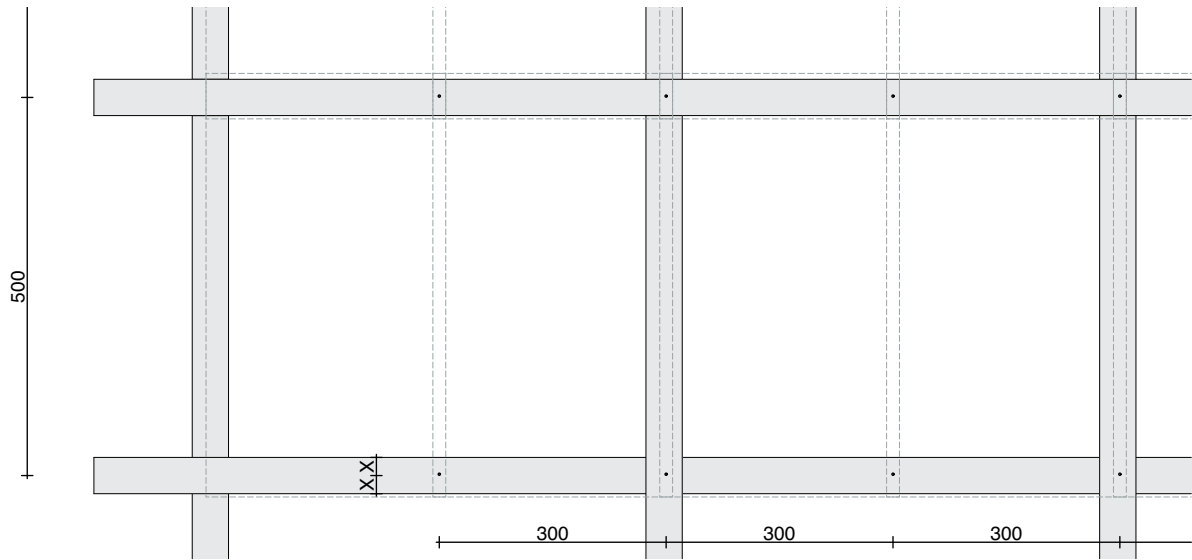

SCREW POSITION

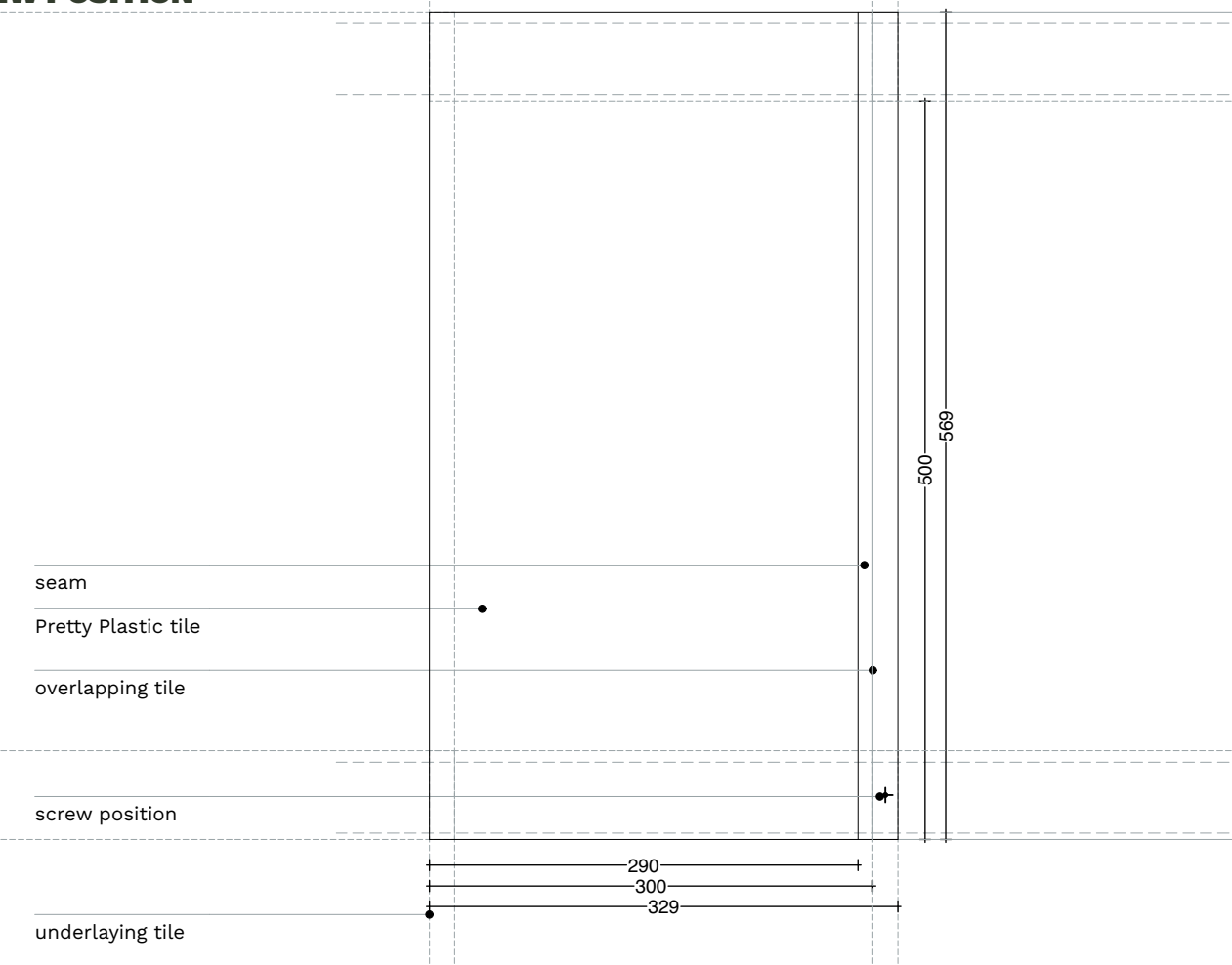

INSTALLATION MANUAL

PRODUCT NAME BASIC THIRD

STEP 1

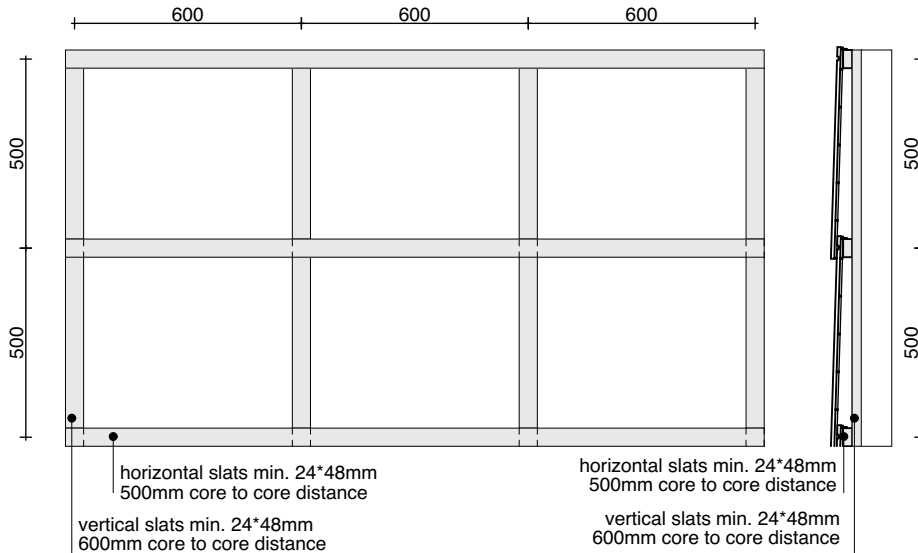

1. Construct a wooden framework in front of the insulated wall.

STEP 2

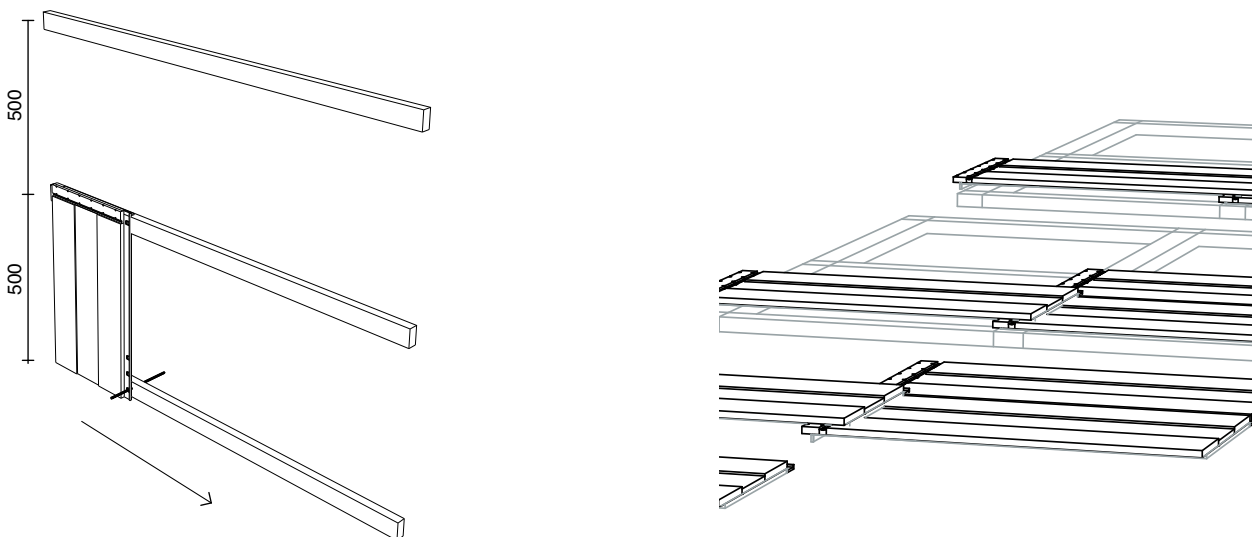

2. Start from the bottom left corner, securing a single screw to the right side at the tile's bottom. Each tile requires only one screw. Use the tab on the back of the tile for easy hanging onto the wood structure. Proceed by installing the tiles sequentially to the right in a row.

INSTALLATION MANUAL

PRODUCT NAME BASIC THIRD

STEP 3

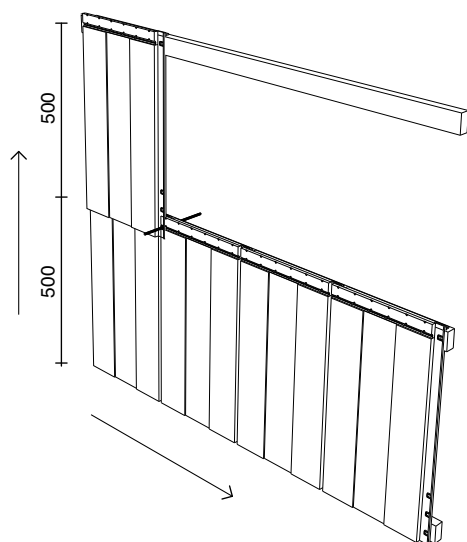

3. After finishing with the first row, move to the next. Use one screw at the bottom right to hold three tiles together.

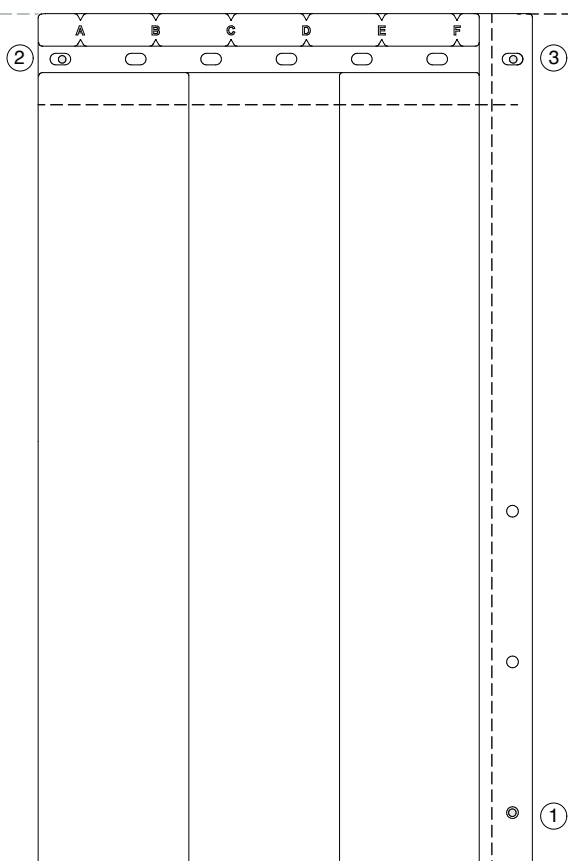

POSITION OF SCREWS

Screw position 1: Attach the screw directly to the tile.

Screw position 2: Automatically screwed when fastening the upper left tile.

Screw position 3: Automatically screwed when fastening the tile above.

INSTALLATION MANUAL

PRODUCT NAME BASIC THIRD

DESIGN SUGGESTIONS

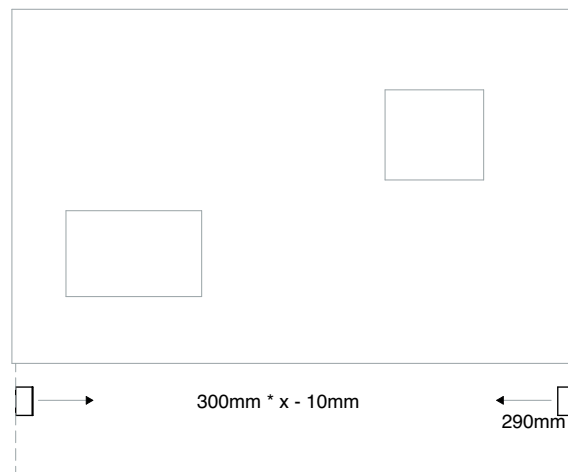
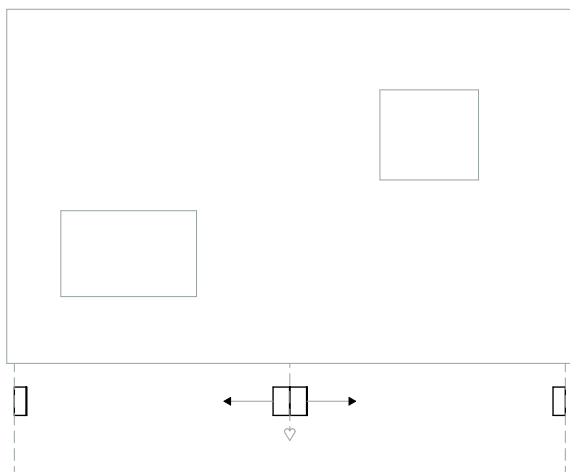

OPTION A

- Begin from the middle, ensuring two identical corner endings.
- Ideal when utilizing a corner profile.

OPTION B

- Start from a corner using a complete tile to achieve a tidy corner.
- Adjust the seam by 3mm more or 10mm less if necessary.

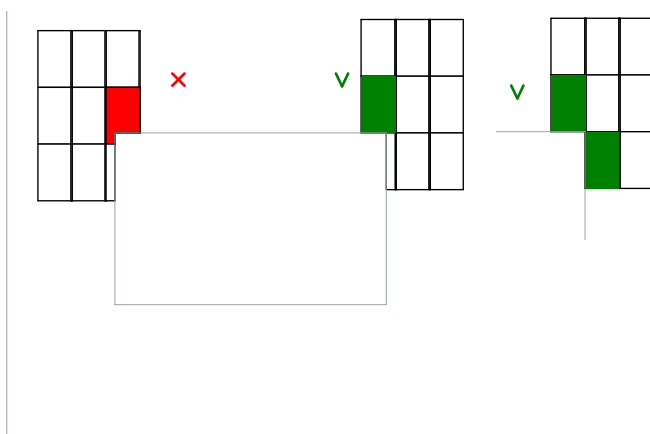

WINDOW CORNERS

Try to cut the tiles in a single direction rather than sawing a corner.

v
300mm * x - 10mm

larger seam:
301mm * x - 11mm
302mm * x - 12mm
303mm * x - 13mm

smaller seam:
299mm * x - 9mm
298mm * x - 8mm
297mm * x - 7mm
296mm * x - 6mm
295mm * x - 5mm
294mm * x - 4mm
293mm * x - 3mm
292mm * x - 2mm
291mm * x - 1mm
290mm * x

INSTALLATION MANUAL

PRODUCT NAME BASIC THIRD

DESIGN SUGGESTIONS

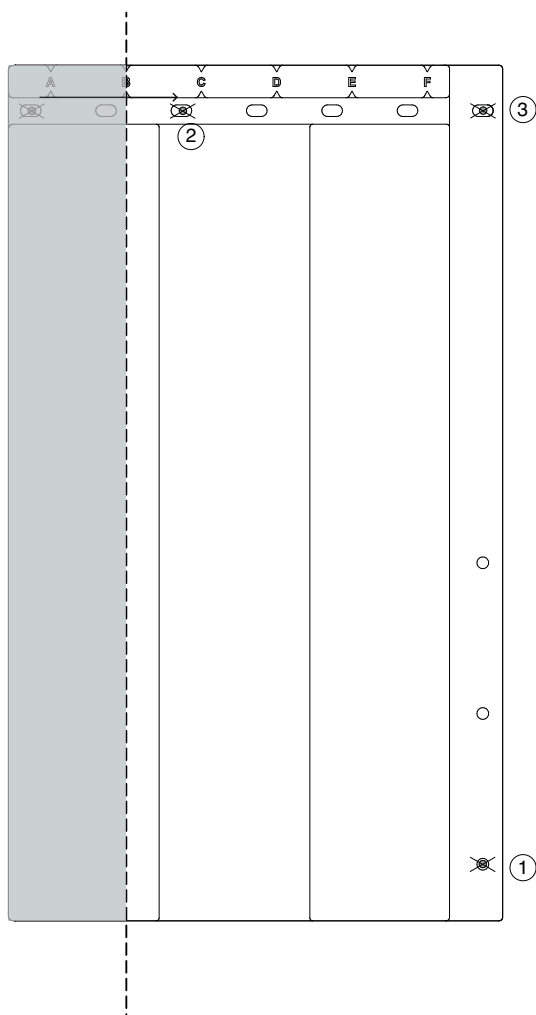

When cutting the tile on the left side, add an extra screw along screw line 2. This screw will go through just one tile instead of three, while still keeping the tile securely in three positions.

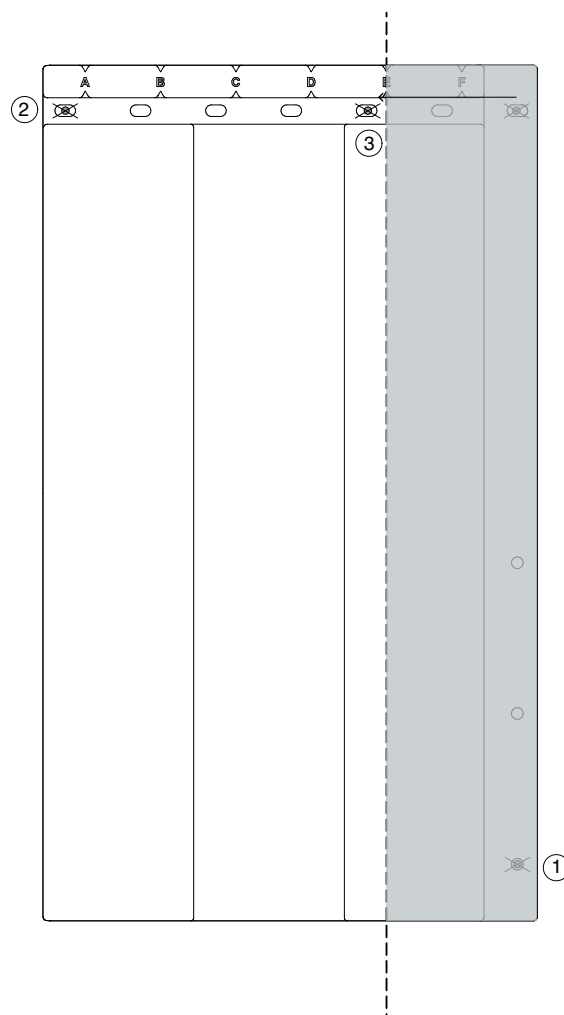

When cutting the tile on the right side, screw position 1 won't work. The tile will be secured in two positions: at screw 2 and position 3 along the line of position 2.

INSTALLATION MANUAL

PRODUCT NAME BASIC THIRD

PATTERN OPTIONS

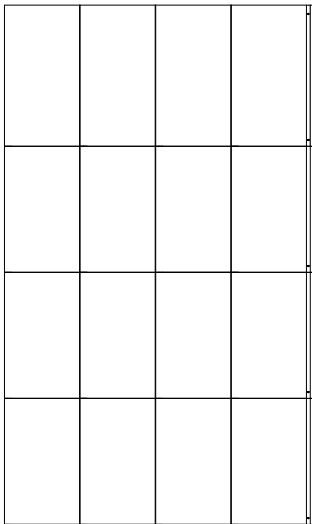

standard pattern
tile bond
300X500mm

use pre-made holes

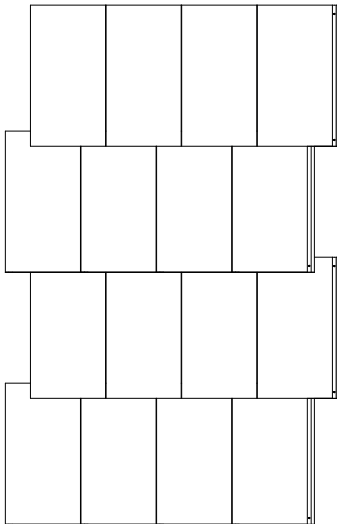

alternative pattern
uneven stretcher bond
300x500mm

use pre-made holes and top
markers for tile alignment

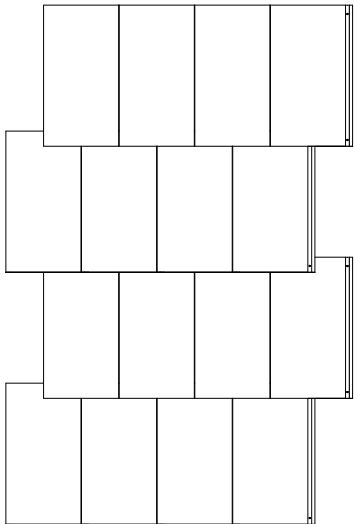

alternative pattern
stretcher bond
300x500mm

use pre-made holes and top
markers for tile alignment

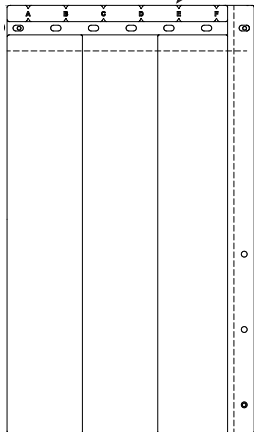

INSTALLATION MANUAL

PRODUCT NAME BASIC THIRD

VERTICAL DISTRIBUTION OPTIONS

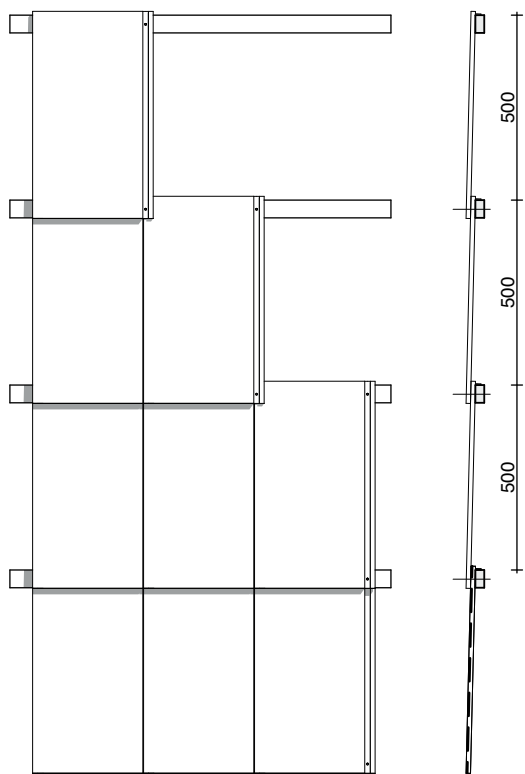

standard pattern
500mm

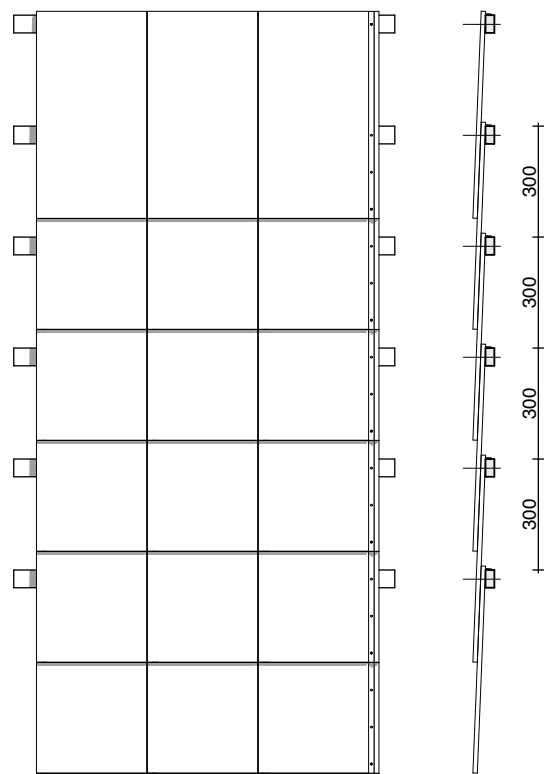

smallest pattern
300mm
(more tiles per m2 are
needed)

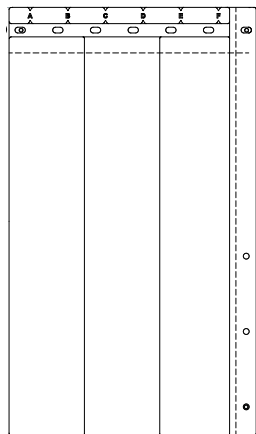

- < screw position 300mm
- < screw position 400mm
- < standard screw position 500mm

INSTALLATION MANUAL

PRODUCT NAME BASIC THIRD

CORNER SOLUTION

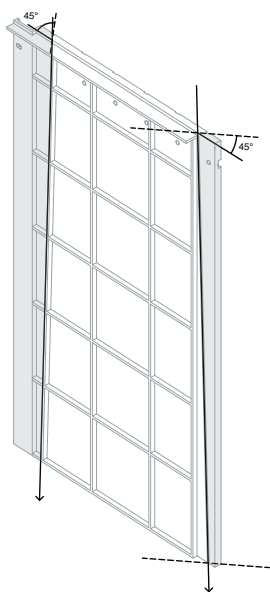

For a neat corner, cut the tile along the angled line marked on the back. This allows two tiles to fit seamlessly together (refer to detail 4 for visual guidance).

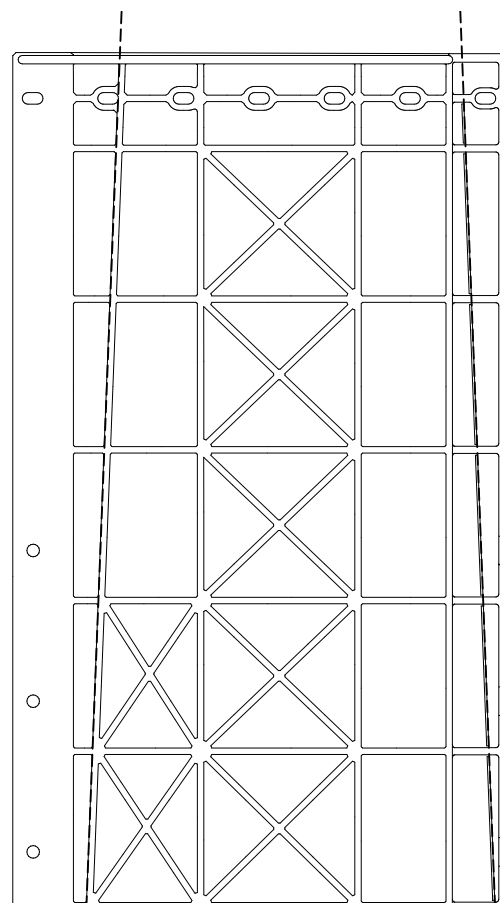

Angled lines are located on the back of the tile to guide the sawing line.

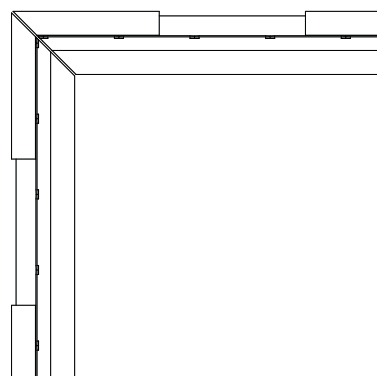

INSTALLATION MANUAL

PRODUCT NAME BASIC THIRD

REPLACING A TILE

STEP 1

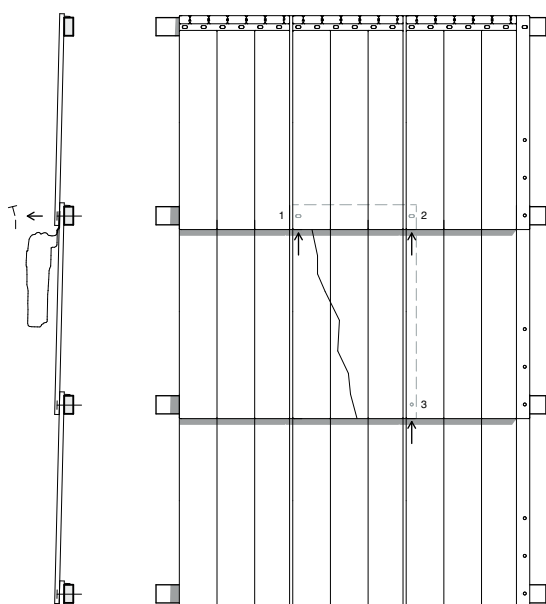

1. Use a multitool to saw off the heads of the screws. This will allow you to remove the tile from the structure. You'll need to saw at three points.

STEP 2

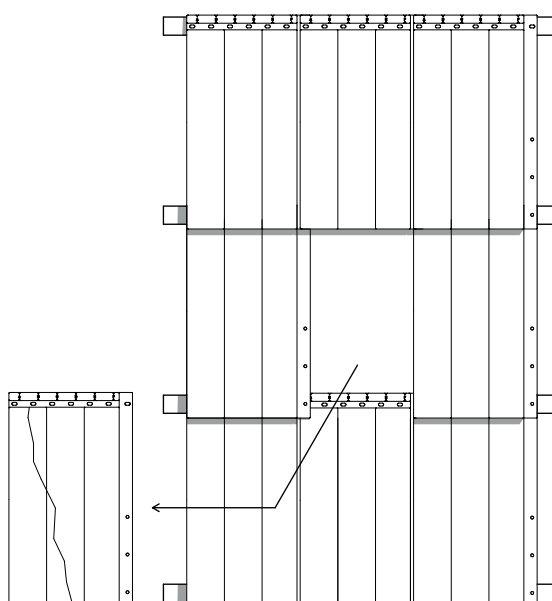

2. Remove the broken tile.

INSTALLATION MANUAL

PRODUCT NAME BASIC THIRD

STEP 3

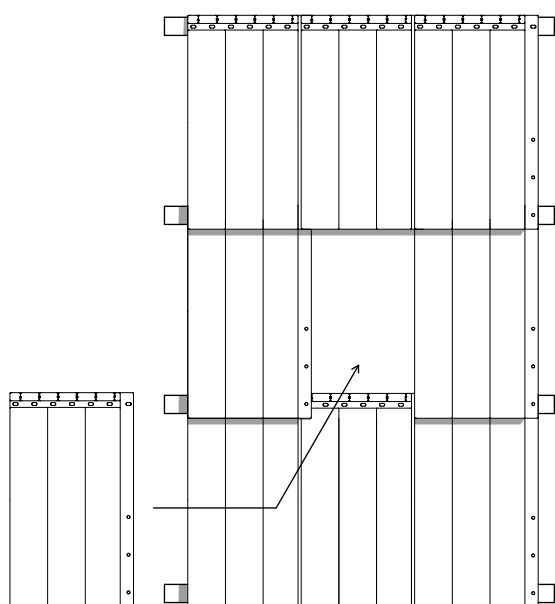

3. Slide a new tile into place.

STEP 4

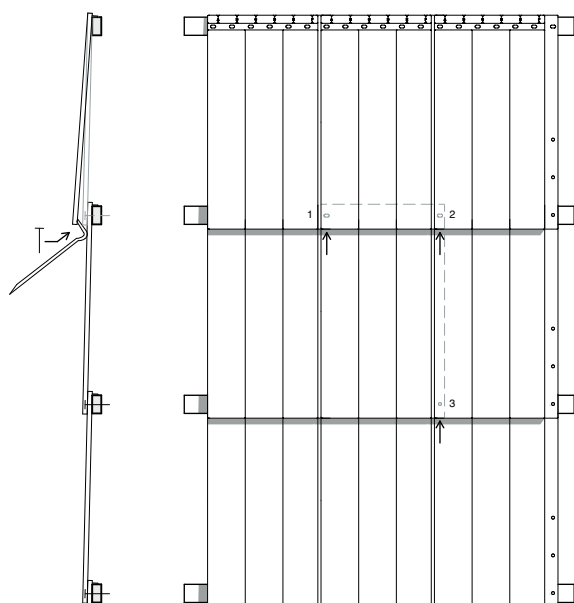

4. Use a pry bar to lift the surrounding tiles slightly. This creates enough space to insert a new screw into the tile.

INSTALLATION MANUAL

PRODUCT NAME BASIC THIRD



reference details

INSTALLATION MANUAL

PRODUCT NAME BASIC THIRD



D1 - TOP CONNECTION WINDOW FRAME

SCALE 1:5

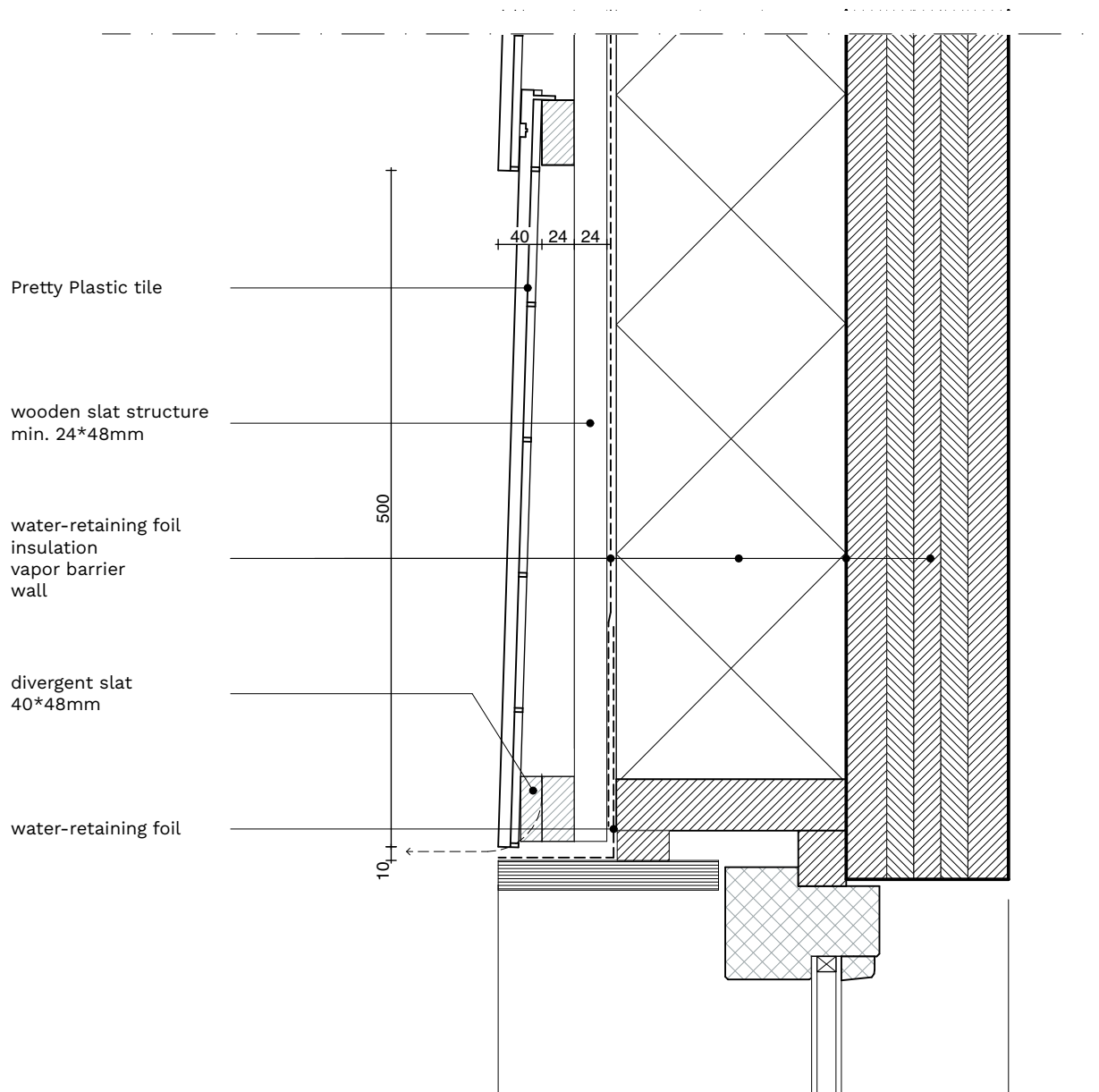

INSTALLATION MANUAL

PRODUCT NAME BASIC THIRD

D2 - BOTTOM CONNECTION WINDOW FRAME

SCALE 1:5

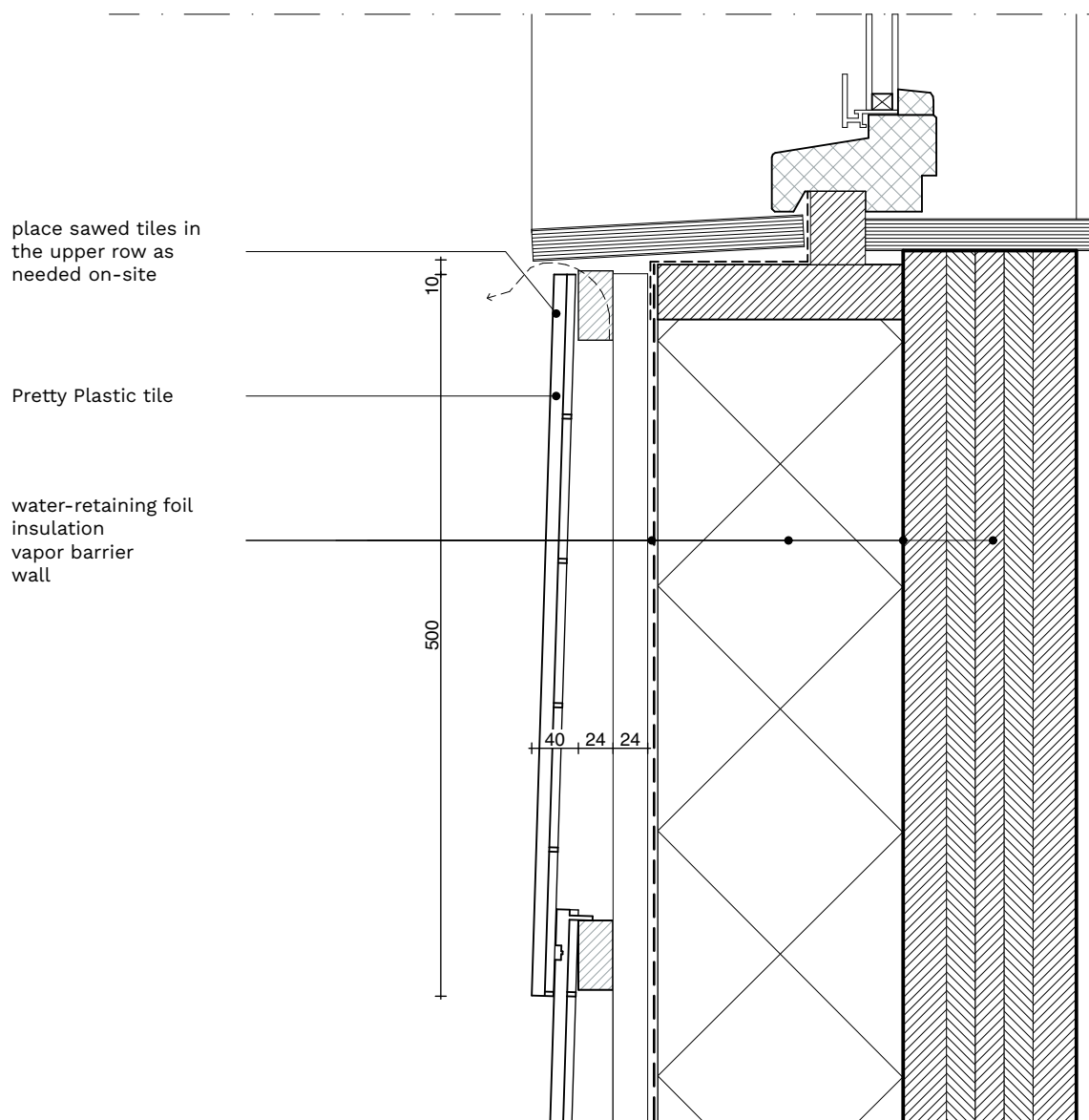

INSTALLATION MANUAL

PRODUCT NAME BASIC THIRD



D3 - WINDOW FRAME HORIZONTAL

SCALE 1:5

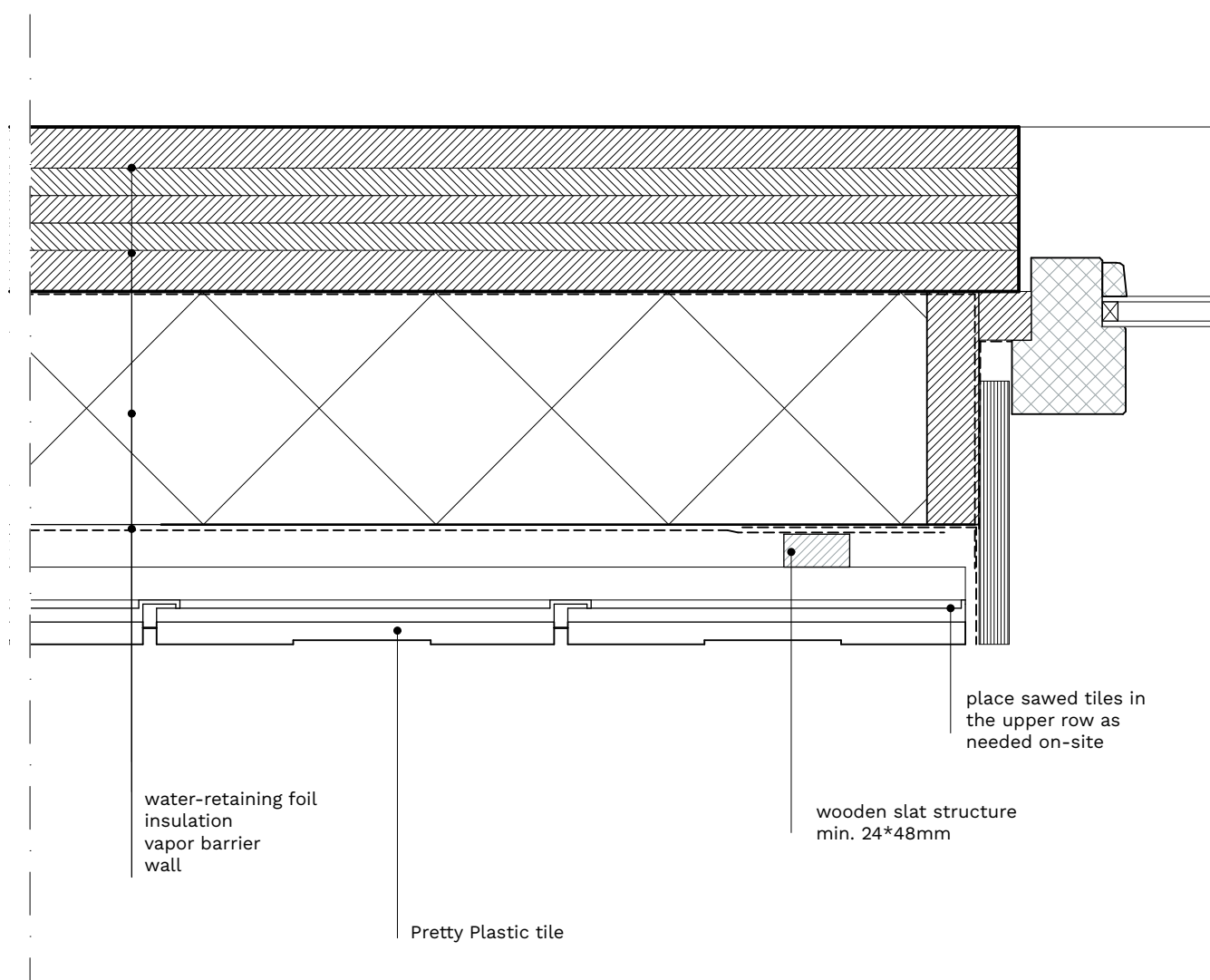

INSTALLATION MANUAL

PRODUCT NAME BASIC THIRD

 **Pretty
Plastic**
building from waste

D4 - CORNER CONNECTION

SCALE 1:5

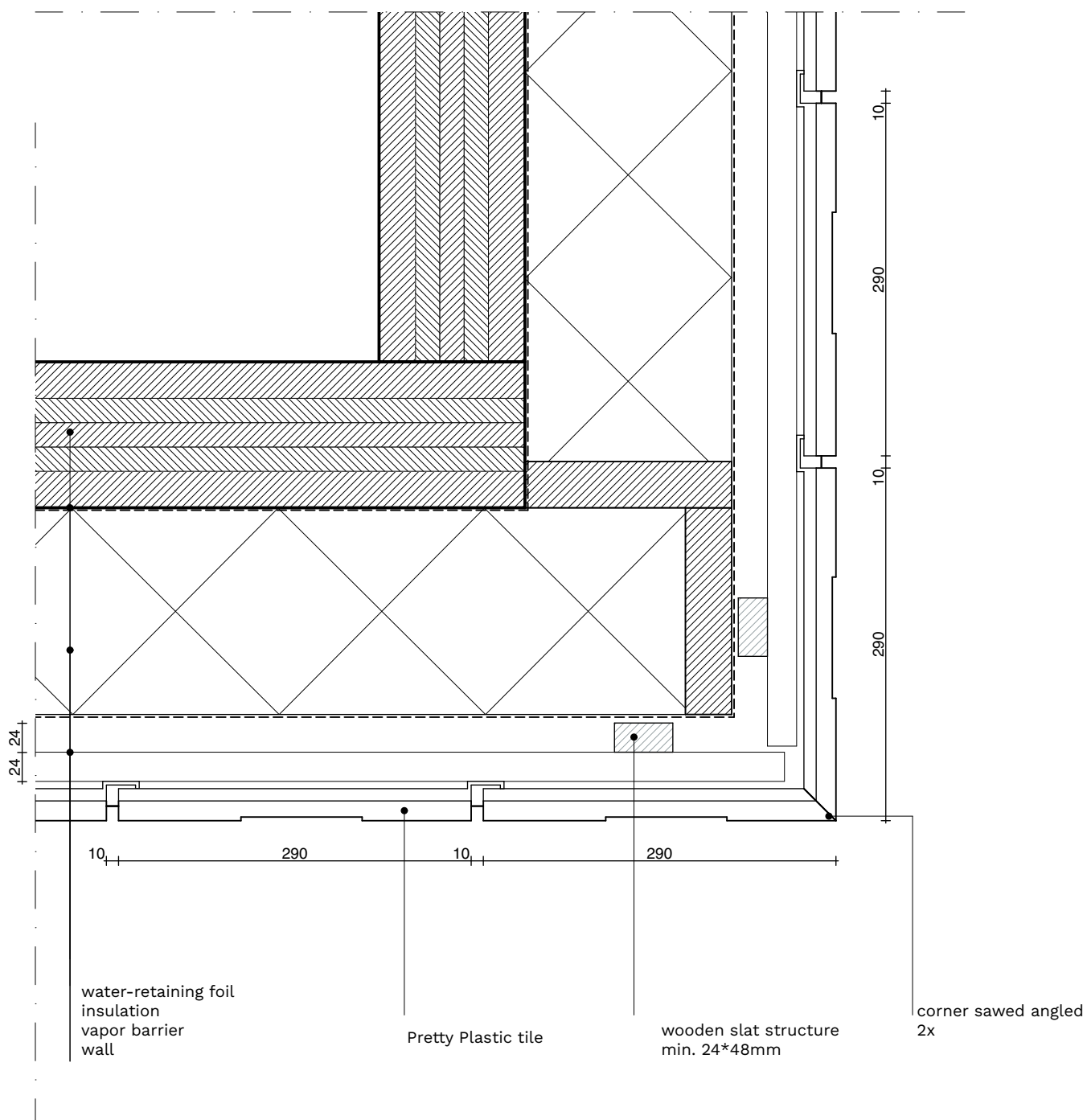

INSTALLATION MANUAL

PRODUCT NAME BASIC THIRD

 Pretty
Plastic
building from waste

D5 - CORNER CONNECTION

SCALE 1:5

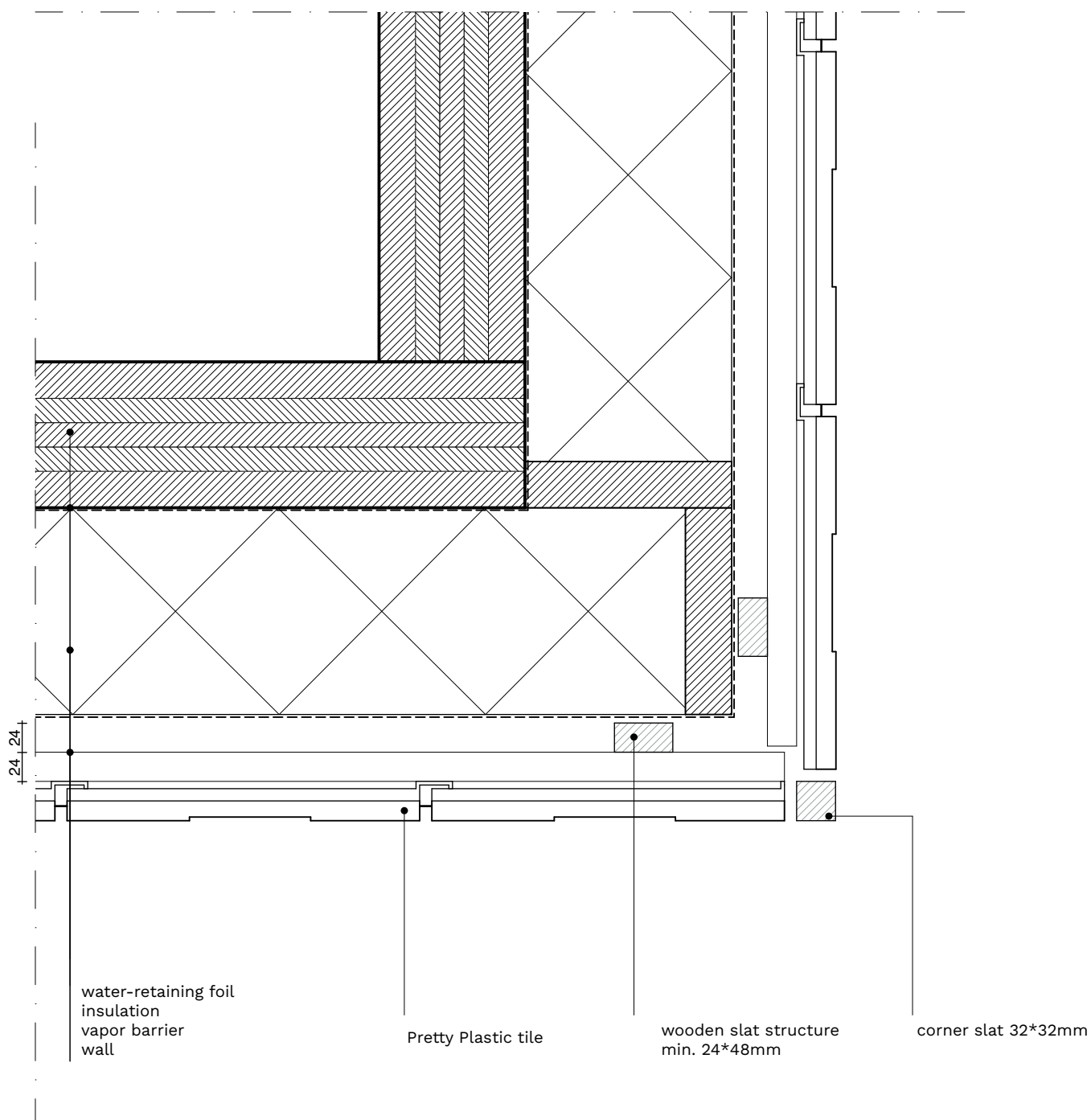

INSTALLATION MANUAL

PRODUCT NAME BASIC THIRD

 **Pretty
Plastic**
building from waste

D6 - CORNER CONNECTION

SCALE 1:5

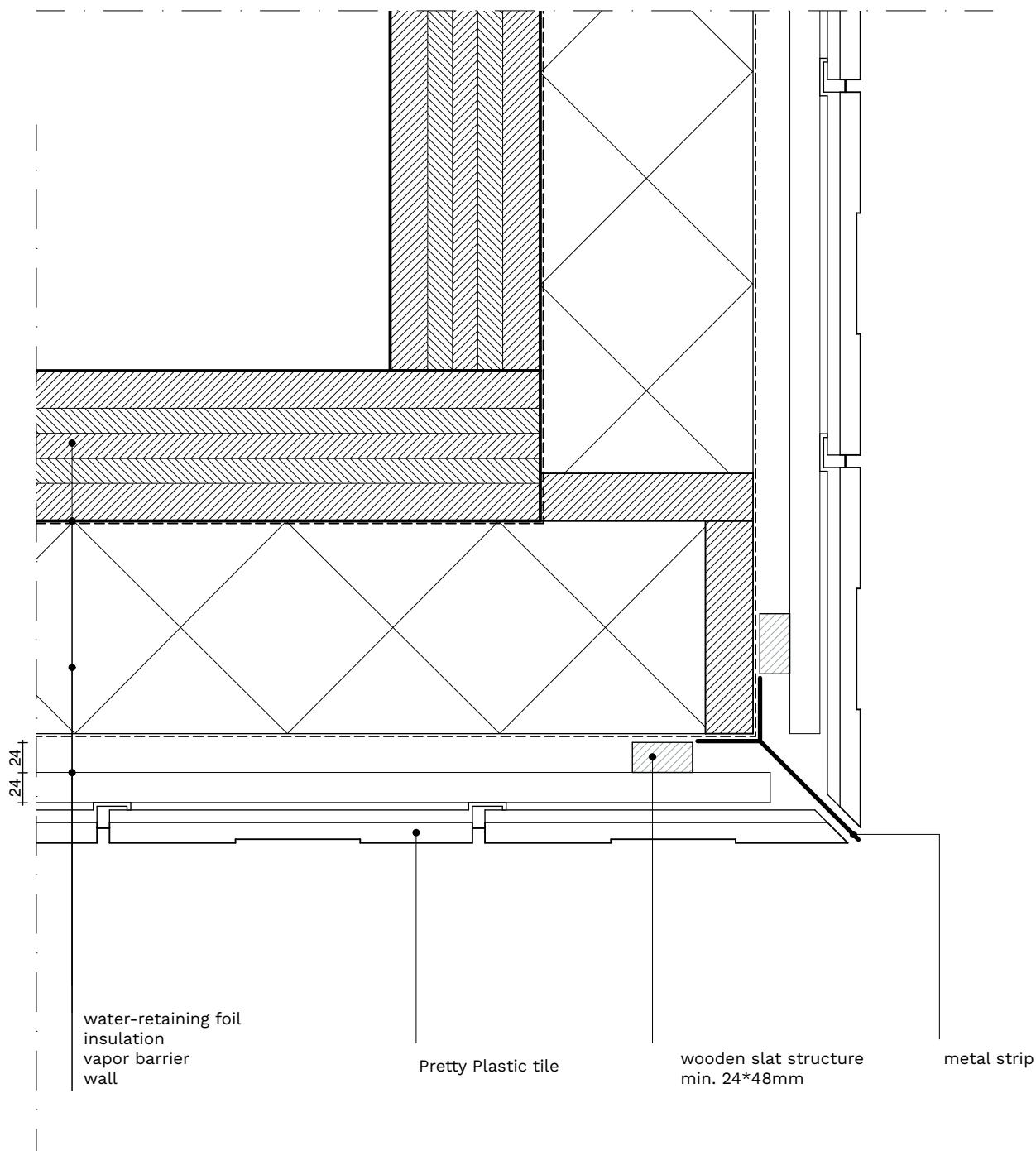



Pretty Plastic B.V.
Karperweg 41
1075 LB Amsterdam
+31 (0)20 2374 993

info@prettyplastic.nl
www.prettyplastic.nl
@we_are_prettyplastic

